

# IMMINGHAM EASTERN RO-RO TERMINAL



Land Plans including Crown Land

Document 10.2.90

APFP Regulations 2009 – Regulation 5(2)(q)

PINS Reference – TR030007

January 2024

# Document Information

Document Information	
<b>Project</b>	Immingham Eastern Ro-Ro Terminal
<b>Document title</b>	Land Plans including Crown Land
<b>Commissioned by</b>	Associated British Ports
<b>Document ref</b>	2.2
<b>APFP Regs</b>	5(2)(q)
<b>Prepared by</b>	ABP Project Team

Date	Version	Revision Details
02/2023	01	Application Submission
01/2024	02	Deadline 8

\\ukfspp02\maritime\PROJECTS\Ports\VT\B2429400-ABP-Project\Sugar\1100 Design & Engineering\1102 Drawings\02 DCO Drawings\B2429400-JAC-00-ZZ-DR-ZZ-0301 - 0301 - GM024629

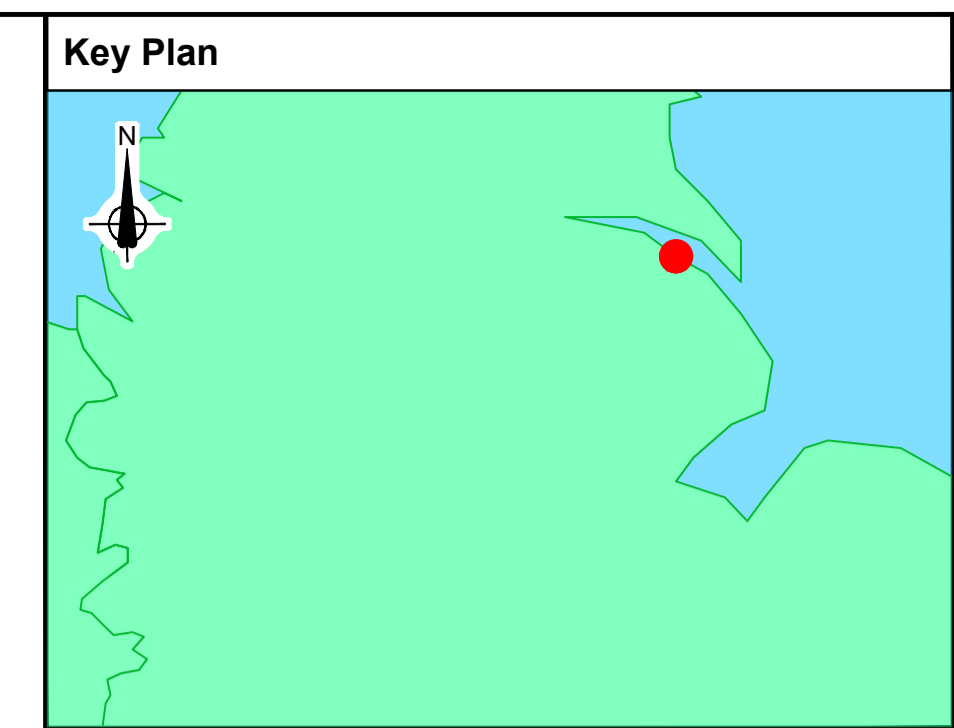
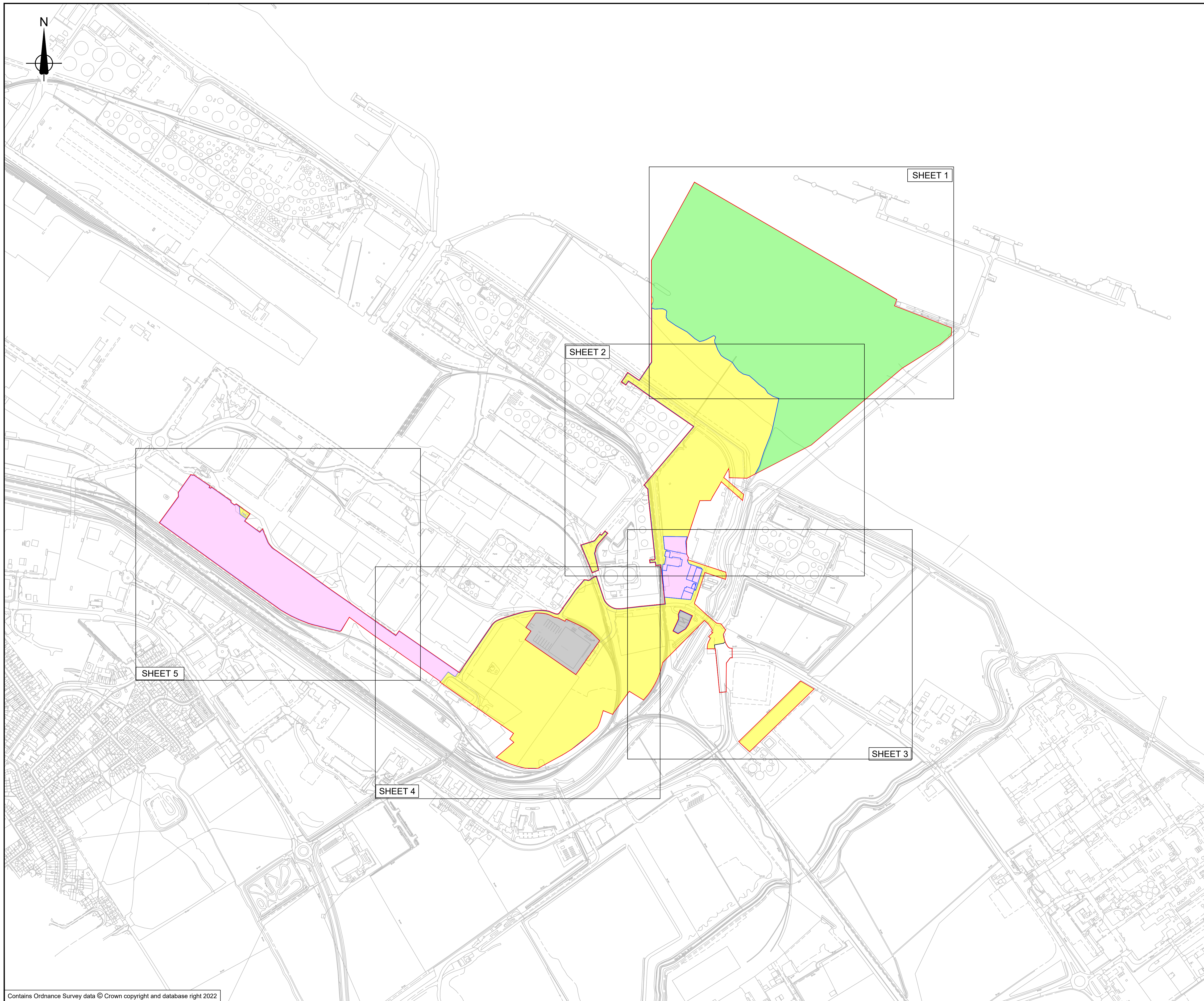

- General Notes:**
- This plan should be read alongside other plans and documents in the development consent order application.
  - All dimensions are in metres unless noted otherwise.

**Legend**

	Order Limits
	Crown Land
	Land in which estates and interests to be permanently acquired
	Land owned by the Applicant and not included within the Book of Reference
	Areas to be excluded from Order Limits
	No compulsory acquisitions sought

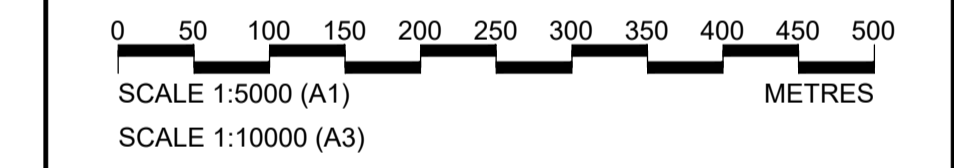

P03	January 2024	Deadline 8 Submission Version	TH	RH	RH	CN
P02	February 2023	Submission Version	BHW	RH	RH	CN
P01	January 2023	Submission Version	BHW	RH	RH	CN
Rev	Rev. Date	Purpose of revision	Orig	Check	Rev	Aprv

**Jacobs**  
 95 Bothwell St, Glasgow, G2 7HX  
 Tel: +44(0)141 243 8000 Fax: +44(0)141 226 3109  
 www.jacobs.com

Client

Project  
**IMMINGHAM EASTERN RO-RO TERMINAL**

Drawing title  
**IMMINGHAM EASTERN RO-RO TERMINAL DEVELOPMENT ORDER 202(X) LAND PLANS REGULATION 5(2)(i) AND 5(2)(n) KEY PLAN FOR LAND PLANS**

Drawing status	DEADLINE 8 SUBMISSION VERSION	Suitability	<b>S4</b>
Scale	1:5000 @ A1		
Jacobs No.	B2429400		
Client No.			Rev P03

Drawing number  
**B2429400-JAC-00-ZZ-DR-ZZ-0301**

\\ukfspp02\Maritime\PROJECTS\Ports\VT\B2429400-ABP-Project\Sugar\1100-Design-Engineering\1102-Drawings\01-Preliminary\02-DCO Drawings\B2429400-JAC-00-ZZ-DR-ZZ-0302 to 0306-PO3.dwg - 04/01/2024 20:43:11 - 0302 - HillsRJ

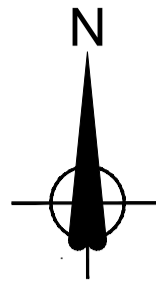

**Key Plan**

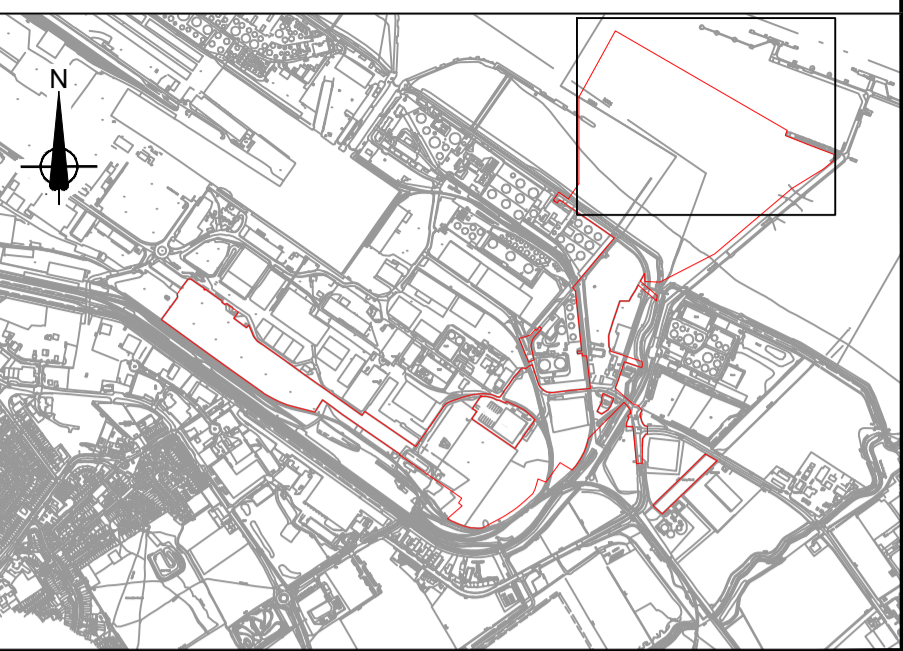

**General Notes**

- 1. This plan should be read alongside other plans and documents in the development consent order application.

**Legend**

- Order Limits
- Crown Land
- Land owned by the Applicant and not included within the Book of Reference

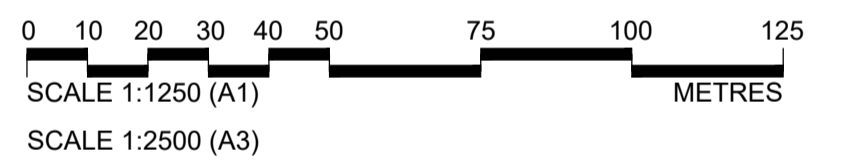

P03	January 2024	Deadline 8 Submission Version	TH	RH	RH	CN
P02	February 2023	Submission Version	BHW	RH	RH	CN
P01	January 2023	Submission Version	BHW	RH	RH	CN
Rev	Rev. Date	Purpose of revision	Orig	Check	Rev	Apprv

**Jacobs**

95 Bothwell St, Glasgow, G2 7HX  
Tel:+44(0)141 243 8000 Fax:+44(0)141 226 3109  
www.jacobs.com

Client



Project

IMMINGHAM EASTERN  
RO-RO TERMINAL

Drawing title

IMMINGHAM EASTERN RO-RO  
TERMINAL DEVELOPMENT  
ORDER 202(X) LAND PLANS  
REGULATION 5(2)(i) AND 5(2)(n)  
SHEET 1 OF 5

Drawing status

DEADLINE 8 SUBMISSION VERSION

Suitability

S4

Scale

1:1250 @ A1

Jacobs No.

B2429400

Client No.

Rev

P03

Drawing number

B2429400-JAC-00-ZZ-DR-ZZ-0302

For continuation see Sheet 2

For continuation see Sheet 1

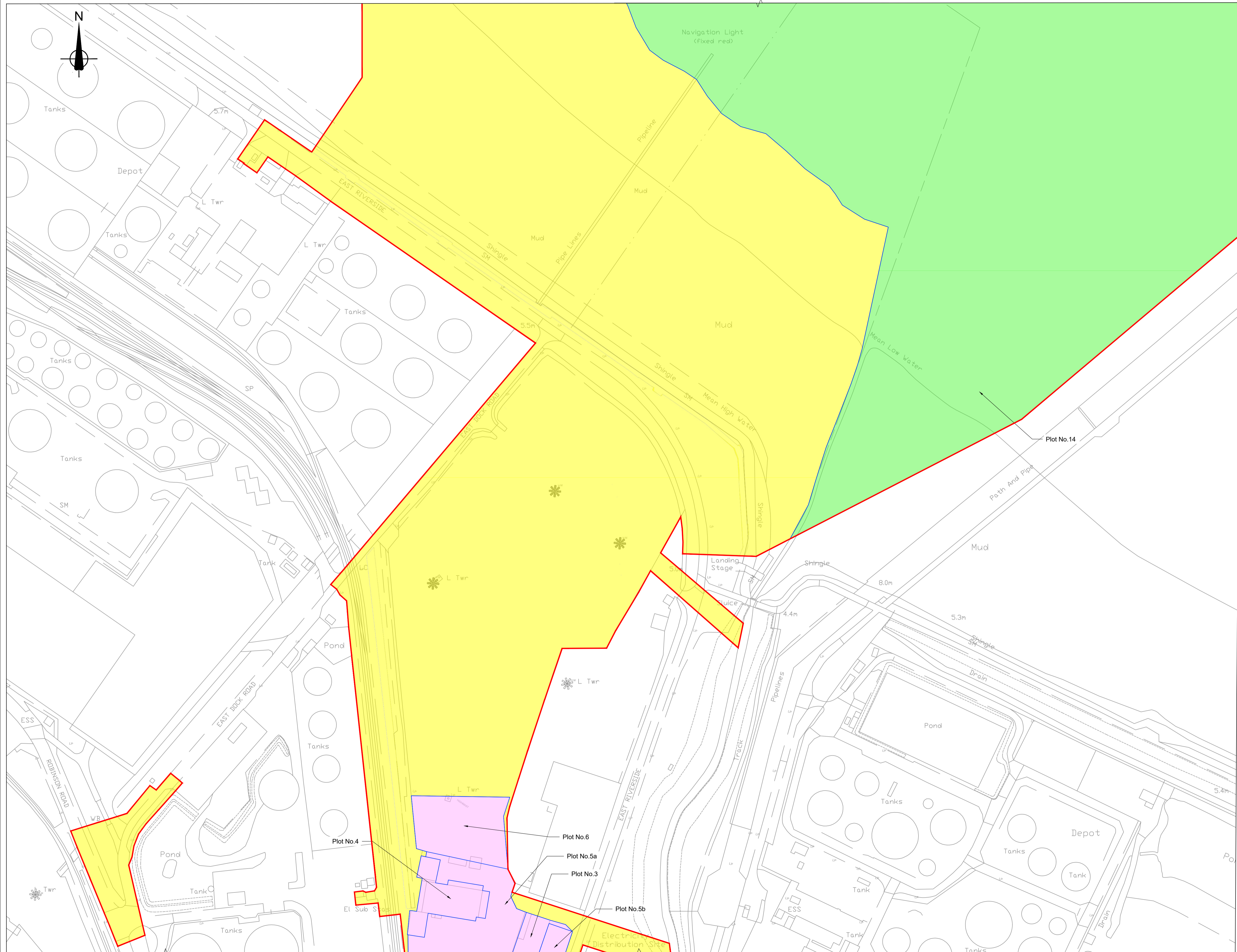

For continuation see Sheet 4

For continuation see Sheet 3

**Key Plan**

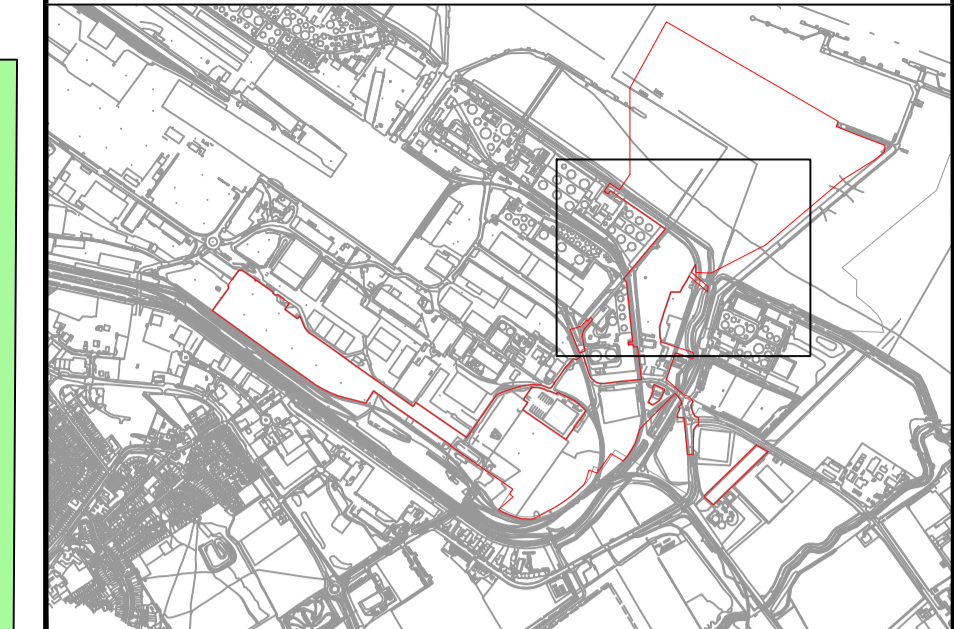

**General Notes**

1. This plan should be read alongside other plans and documents in the development consent order application.

**Legend**

- Order Limits.
- Crown Land
- Land in which estates and interests to be permanently acquired
- Land owned by the Applicant and not included within the Book of Reference

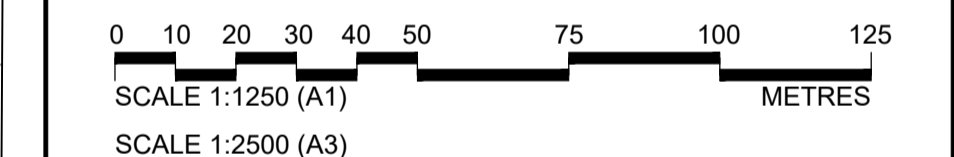

P03	January 2024	Deadline 8 Submission Version	TH	RH	RH	CN
P02	February 2023	Submission Version	BHW	RH	RH	CN
P01	January 2023	Submission Version	BHW	RH	RH	CN
Rev	Rev. Date	Purpose of revision	Orig	Check	Rev	Apprv

**Jacobs**  
 95 Bothwell St, Glasgow, G2 7HX  
 Tel: +44(0)141 243 8000 Fax: +44(0)141 226 3109  
 www.jacobs.com

Client

**ABP ASSOCIATED BRITISH PORTS**

Project

**IMMINGHAM EASTERN RO-RO TERMINAL**

Drawing title

**IMMINGHAM EASTERN RO-RO TERMINAL DEVELOPMENT ORDER 202(X) LAND PLANS REGULATION 5(2)(i) AND 5(2)(n) SHEET 2 OF 5**

Drawing status

**DEADLINE 8 SUBMISSION VERSION**

Suitability **S4**

Scale: 1:1250 @ A1

Jacobs No. B2429400

Client No. Rev P03

Drawing number

**B2429400-JAC-00-ZZ-DR-ZZ-0303**

© Copyright 2022 Jacobs U.K. Limited. The concepts and information contained in this document are the property of Jacobs. Use or copying of this document in whole or in part without the written permission of Jacobs constitutes an infringement of copyright. Limitation: This drawing has been prepared on behalf of, and for the exclusive use of, Jacobs' Client, and is subject to, and issued in accordance with, the provisions of the contract between Jacobs and the Client. Jacobs accepts no liability or responsibility whatsoever for, or in respect of, any use of, or reliance upon, this drawing by any third party.

\\ukfsp02\marine\PROJECTS\Ports\VT\B2429400-ABP-Project\Sugar\1100-Design-&Engineering\1102-Drawings\01-Preliminary\02-DCO-Drawings\B2429400-JAC-00-ZZ-DR-ZZ-0302 to 0306-P03.dwg - 05/01/2024 19:37:44 - 0303 - GM024629

For continuation see Sheet 2

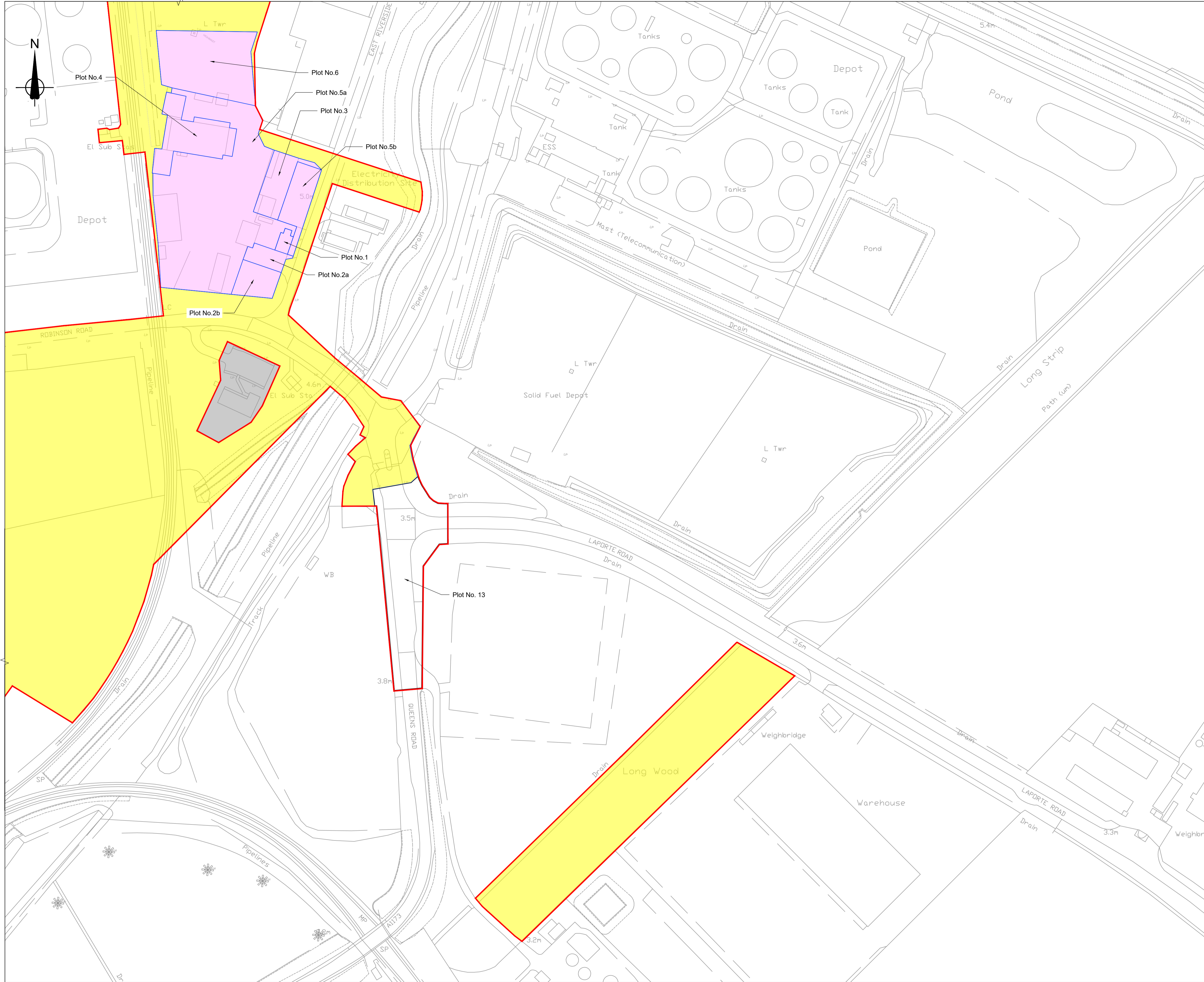

For continuation see Sheet 4

### Key Plan

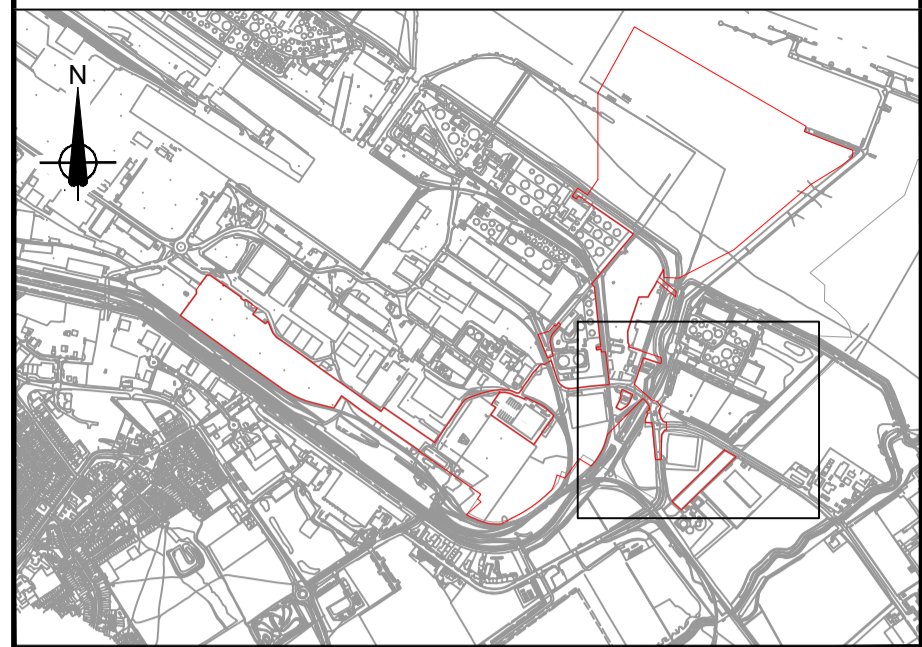

### General Notes

- This plan should be read alongside other plans and documents in the development consent order application.

### Legend

- Order Limits
- Areas to be excluded from Order Limits
- Land in which estates and interests to be permanently acquired
- Land owned by the Applicant and not included within the Book of Reference
- No compulsory acquisition powers sought.

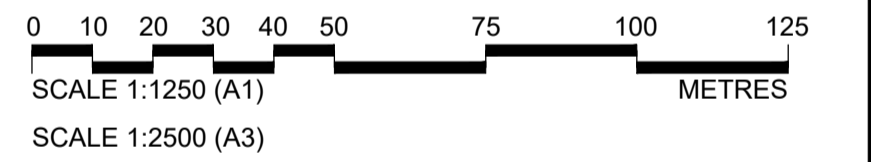

P03	January 2024	Deadline 8 Submission Version	TH	RH	RH	CN
P02	February 2023	Submission Version	BHW	RH	RH	CN
P01	January 2023	Submission Version	BHW	RH	RH	CN
Rev	Rev. Date	Purpose of revision	Orig	Check	Rev	Apprv

## Jacobs

95 Bothwell St, Glasgow, G2 7HX  
Tel: +44(0)141 243 8000 Fax: +44(0)141 226 3109  
www.jacobs.com



Client  
**IMMINGHAM EASTERN RO-RO TERMINAL**

Drawing title  
**IMMINGHAM EASTERN RO-RO TERMINAL DEVELOPMENT ORDER 202(X) LAND PLANS REGULATION 5(2)(i) AND 5(2)(n) SHEET 3 OF 5**

Drawing status **DEADLINE 8 SUBMISSION VERSION** Suitability **S4**

Scale 1:1250 @ A1

Jacobs No. B2429400 Rev P03

Client No.

Drawing number **B2429400-JAC-00-ZZ-DR-ZZ-0304**

© Copyright 2022 Jacobs U.K. Limited. The concepts and information contained in this document are the property of Jacobs. Use or copying of this document in whole or in part without the written permission of Jacobs constitutes an infringement of copyright. Limitation: This drawing has been prepared on behalf of, and for the exclusive use of, the Client, and is subject to, and issued in accordance with, the provisions of the contract between Jacobs and the Client. Jacobs accepts no liability or responsibility whatsoever for, or in respect of, any use of, or reliance upon, this drawing by any third party.

For continuation see Sheet 2

Key Plan

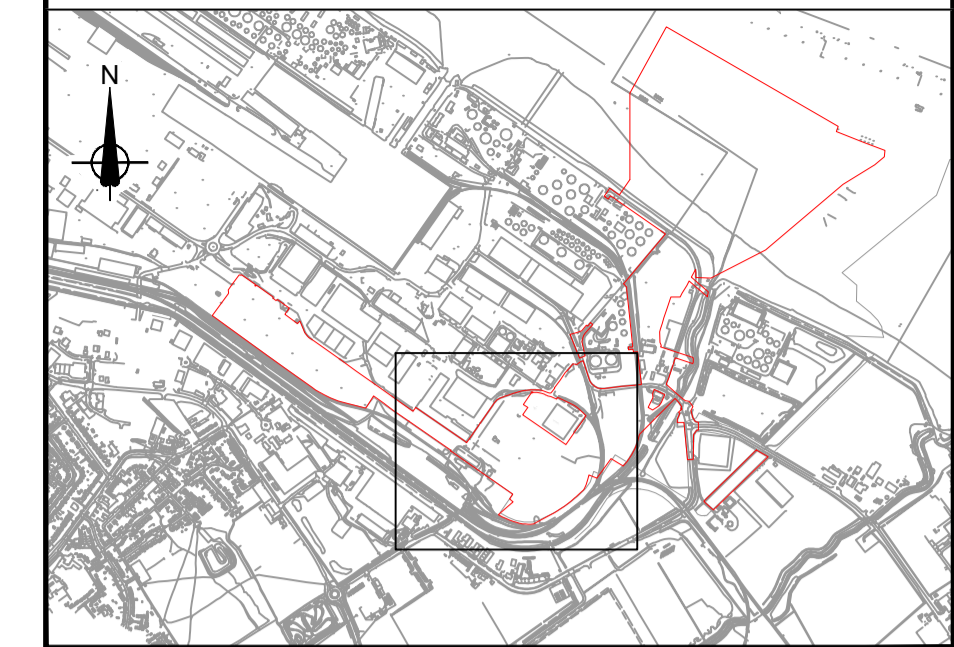

General Notes

1. This plan should be read alongside other plans and documents in the development consent order application.

Legend

- Order Limits.
- Land in which estates and interests to be permanently acquired
- Land owned by the Applicant and not included within the Book of Reference
- Areas to be excluded from Order Limits

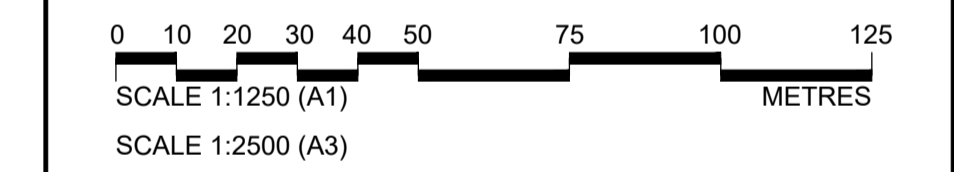

P03	January 2024	Deadline 8 Submission Version	TH	RH	RH	CN
P02	February 2023	Submission Version	TH	RH	RH	CN
P01	January 2023	Submission Version	BHW	RH	RH	CN
Rev	Rev. Date	Purpose of revision	Orig	Check	Rev	Apprv

**Jacobs**  
95 Bothwell St, Glasgow, G2 7HX  
Tel:+44(0)141 243 8000 Fax:+44(0)141 226 3109  
www.jacobs.com

Client  
**ABP ASSOCIATED BRITISH PORTS**

Project  
**IMMINGHAM EASTERN RO-RO TERMINAL**

Drawing title  
**IMMINGHAM EASTERN RO-RO TERMINAL DEVELOPMENT ORDER 202(X) LAND PLANS REGULATION 5(2)(i) AND 5(2)(n) SHEET 4 OF 5**

Drawing status  
**DEADLINE 8 SUBMISSION VERSION** Suitability **S4**

Scale  
1:1250 @ A1

Jacobs No.  
B2429400 Rev  
Client No.  
P03

Drawing number  
**B2429400-JAC-00-ZZ-DR-ZZ-0305**

© Copyright 2022 Jacobs U.K. Limited. The concepts and information contained in this document are the property of Jacobs. Use or copying of this document in whole or in part without the written permission of Jacobs constitutes an infringement of copyright. Limitation: This drawing has been prepared on behalf of, and for the exclusive use of, Jacobs' Client, and is subject to, and issued in accordance with, the provisions of the contract between Jacobs and the Client. Jacobs accepts no liability or responsibility whatsoever for, or in respect of, any use of, or reliance upon, this drawing by any third party.

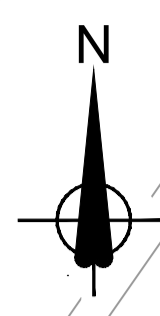
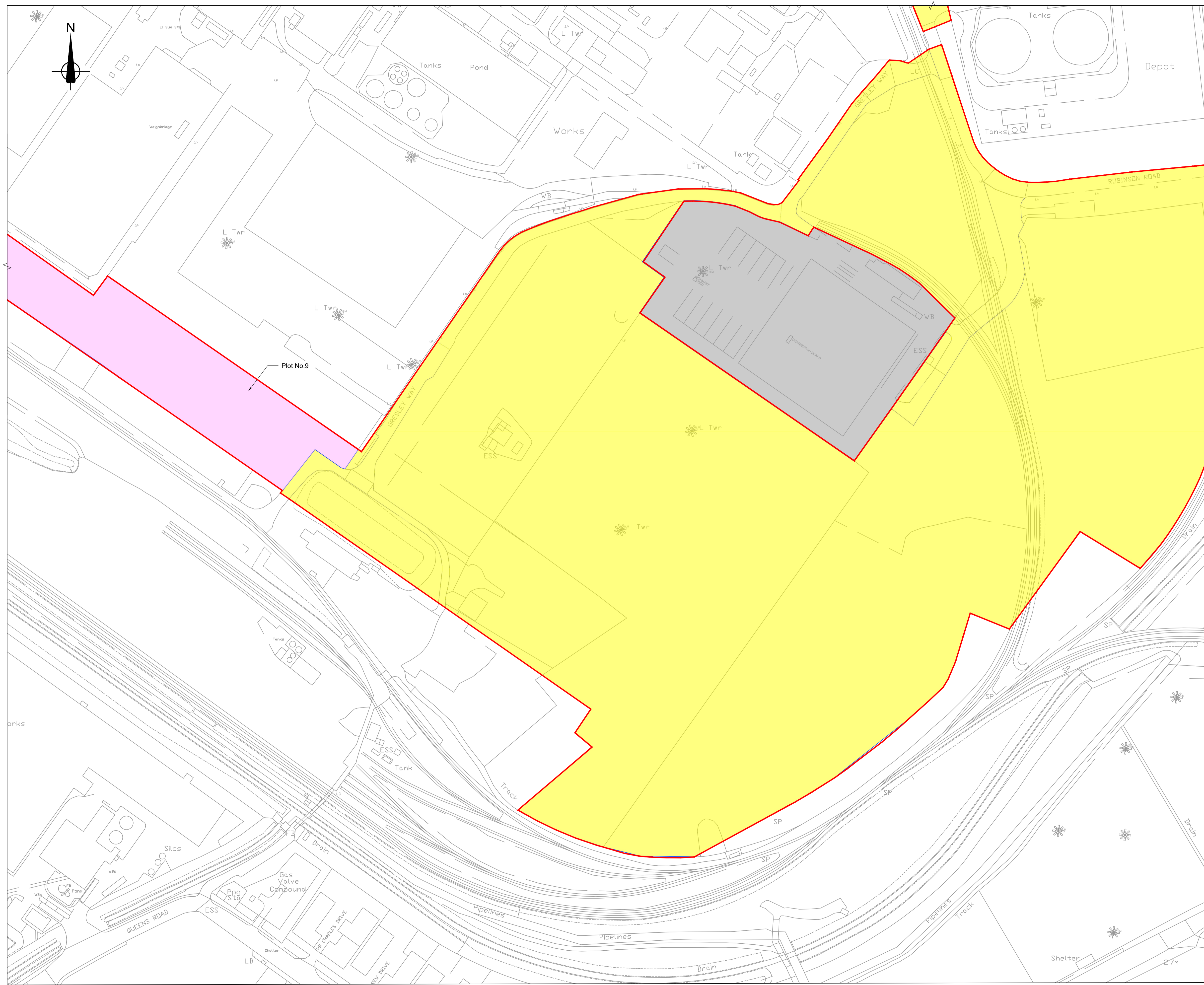

For continuation see Sheet 5

For continuation see Sheet 3

\\ukfsp02\Maritime\PROJECTS\Ports\VT\B2429400 ABP Project Sugar\1100 Design & Engineering\1102 Drawings\01 Preliminary\02 DCO Drawings\B2429400-JAC-00-ZZ-DR-ZZ-0302 to 0306 P03.dwg - 04/01/2024 20:59:11 - 0305 - HillsRJ

\\ukfsp02\Maritime\PROJECTS\Ports\VT\B2429400 ABP Project Sugar 1100 Design & Engineering\1102 Drawings\01 Preliminary\02 DCO Drawings\B2429400-JAC-00-ZZ-DR-ZZ-0306 - 04/01/2024 21:09:52 - 0306 - HillsRU

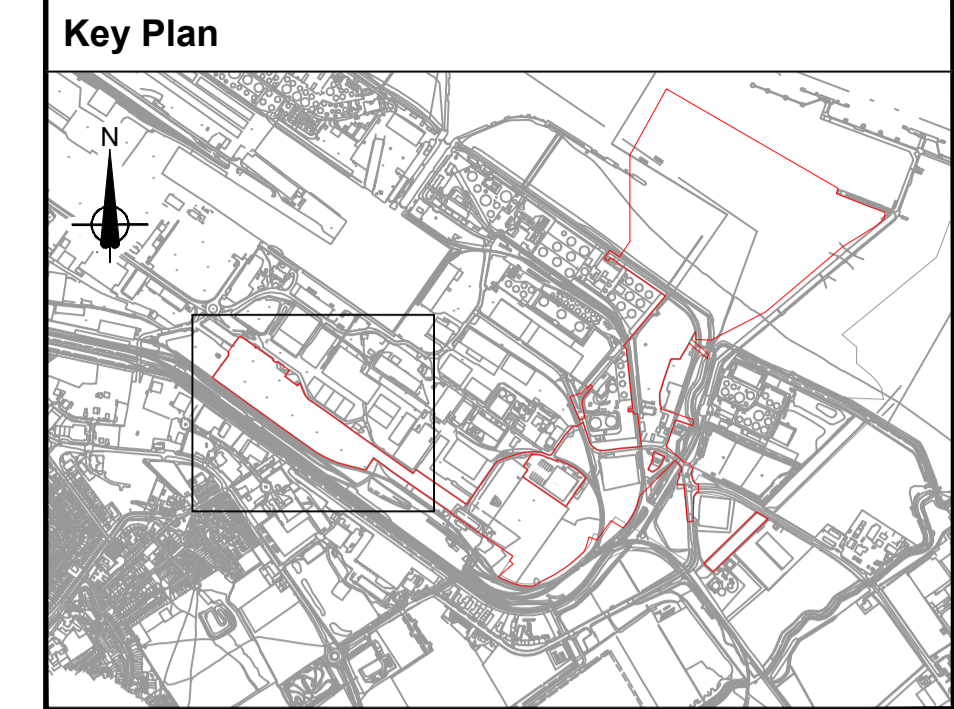
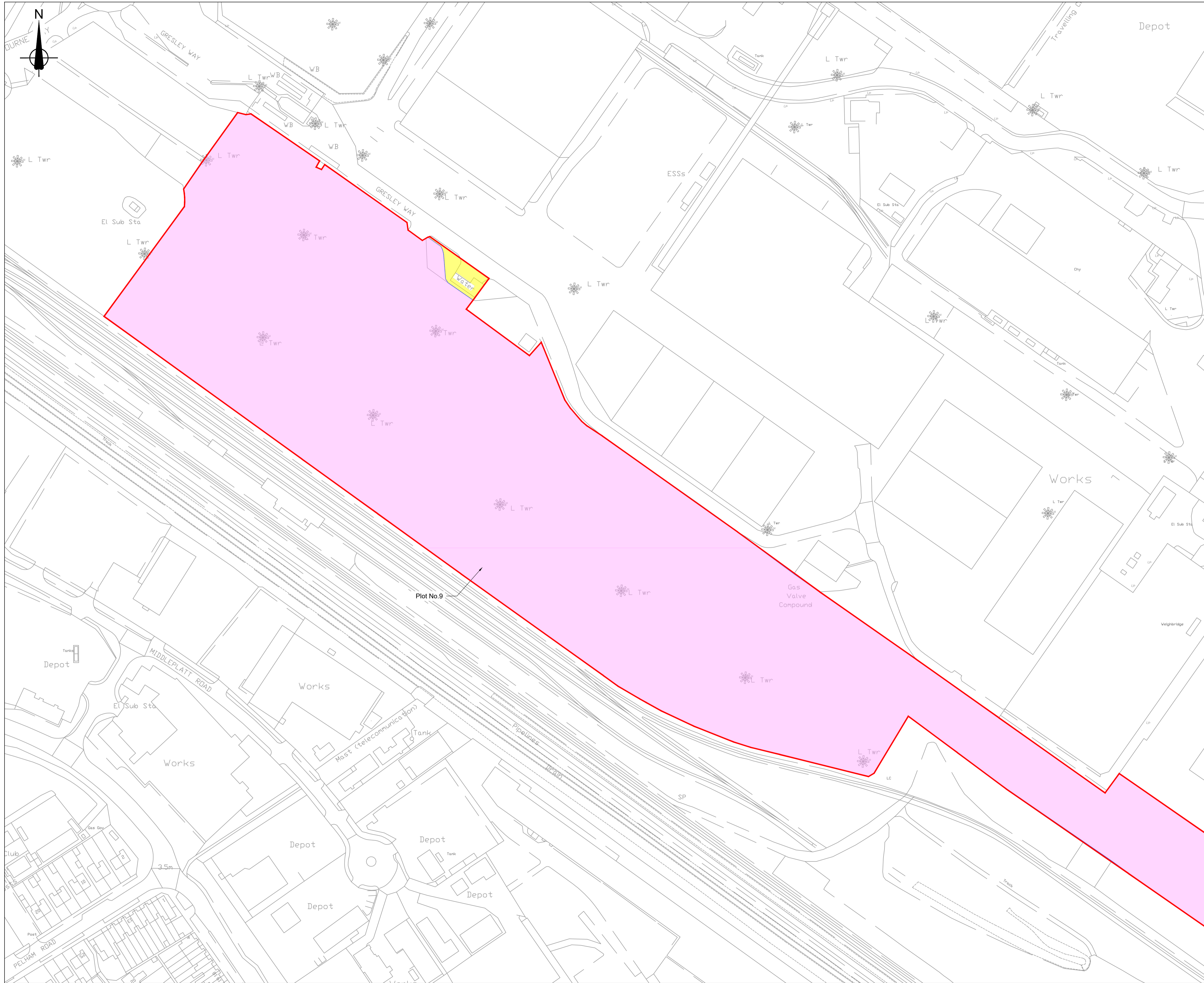

**General Notes**  
 1. This plan should be read alongside other plans and documents in the development consent order application.

- Legend**
- Order Limits
  - Land in which estates and interests to be permanently acquired
  - Land owned by the applicant not included within the Book of Reference

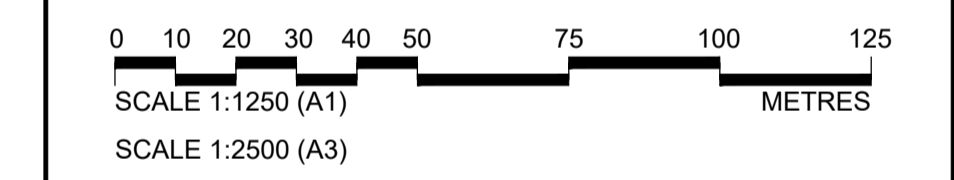

P03	January 2024	Deadline 8 Submission Version	TH	RH	RH	CN
P02	February 2023	Submission Version	TH	RH	RH	CN
P01	January 2023	Submission Version	BHW	RH	RH	CN
Rev	Rev. Date	Purpose of revision	Orig	Check	Rev	Apprv

**Jacobs**  
 95 Bothwell St, Glasgow, G2 7HX  
 Tel: +44(0)141 243 8000 Fax: +44(0)141 226 3109  
 www.jacobs.com

Client

Project  
**IMMINGHAM EASTERN RO-RO TERMINAL**

Drawing title  
**IMMINGHAM EASTERN RO-RO TERMINAL DEVELOPMENT ORDER 202(X) LAND PLANS REGULATION 5(2)(i) AND 5(2)(n) SHEET 5 OF 5**

Drawing status **DEADLINE 8 SUBMISSION VERSION** Suitability **S4**

Scale 1:1250 @ A1  
 Jacobs No. B2429400 Rev P03  
 Client No.

Drawing number  
**B2429400-JAC-00-ZZ-DR-ZZ-0306**

© Copyright 2022 Jacobs U.K. Limited. The concepts and information contained in this document are the property of Jacobs. Use or copying of this document in whole or in part without the written permission of Jacobs constitutes an infringement of copyright. Limitation: This drawing has been prepared on behalf of, and for the exclusive use of, the Client, and is subject to, and issued in accordance with, the provisions of the contract between Jacobs and the Client. Jacobs accepts no liability or responsibility whatsoever for, or in respect of, any use of, or reliance upon, this drawing by any third party.

For continuation see Sheet 4